



Type:	RESIDENTIAL STORABLE POOL PLAN
Process Date:	
Appl. #:	

RESIDENTIAL STORABLE POOL PLAN

This plan must be accompanied by an appropriate building permit application.

FILL IN ALL APPROPRIATE SECTIONS – PLEASE PRINT – MUST BE LEGIBLE

PART I – GENERAL PROJECT NOTES & INFORMATION

Plans will be reviewed as submitted. Any changes to plans must be submitted for review and approval prior to requesting an inspection.

POOL DESCRIPTION:

(if available please provide manufacturer’s specifications and installation information)

Depth: _____ inches

Size: _____ ft X _____ ft

Type of Pool:

- Inflatable, no frame
- Metal Shell w/liner – metal frame
- Vinyl liner – PVC/ Plastic frame
- Vinyl liner – metal frame
- Other, please specify: _____

Shape of Pool:

- Rectangular/ Square
- Oval
- Circular/ Round
- Other, please specify: _____

POOL ACCESS INFORMATION:

(must choose one option from below, if full yard fencing not provided)

- Pool deck to be provided, please note that additional drawings to furnish details on the deck to be provided are required.



- Pool ladder surround to be provided, for ladder access only, pool wall must be 48” height or greater.



Ladder Surround requirements as follows:

- a. Guards must be a minimum of 48” high with no larger than 4” openings.
- b. Self-closing/ Self-latching gate(s)

An affidavit from the owner is required to make a building permit application if the permit applicant is not the owner of the property.

FENCE INFORMATION:

- Existing fencing will be used, please describe: _____
- New fencing will be provided (a fence permit is required).

Height of fencing: _____ inches (48” min - 72” max)

Are there gates provided in the fencing? Yes No

If yes, indicate on plot drawing the locations of all gates.

Please note all gates provided must be self-closing/ self-latching.

ELECTRICAL/ PUMP NOTES:

Extension cords are not permitted for providing power to the pump.

A grounded GFCI receptacle is required for the pump.

The required receptacle is to be located within 6ft minimum and 20ft maximum of the pump, depending on the length of the manufacturer provided power cord.

All electrical work must be completed with proper permits by a City licensed electrical contractor.

ZONING SETBACK REQUIREMENTS:

Pools are not permitted in the front yard of a property.

Side property line setback – 4ft

Rear property line setback – 5ft

Pool must maintain a minimum of 3ft from the house or any attached structure. If the pool uses a deck that is attached to the house, then it must meet the house minimum setback requirements.

PART II – PROPERTY & LOCATION INFORMATION

Indicate the following on the PLOT PLAN:

- | | |
|---|---|
| 1. House and driveway or parking areas | 6. Any accessory structures (sheds, fencing, etc.) |
| 2. Lot Lines, Streets, and Alleyways | 7. Location of pool access (deck or ladder surround) |
| 3. Pool location and depth | 8. Electric meter location |
| 4. Distance from lot lines to pool edge | 9. Electric, telephone, cable wiring from utility service poles to home (overhead or underground) |
| 5. Location of required GFCI receptacle | |

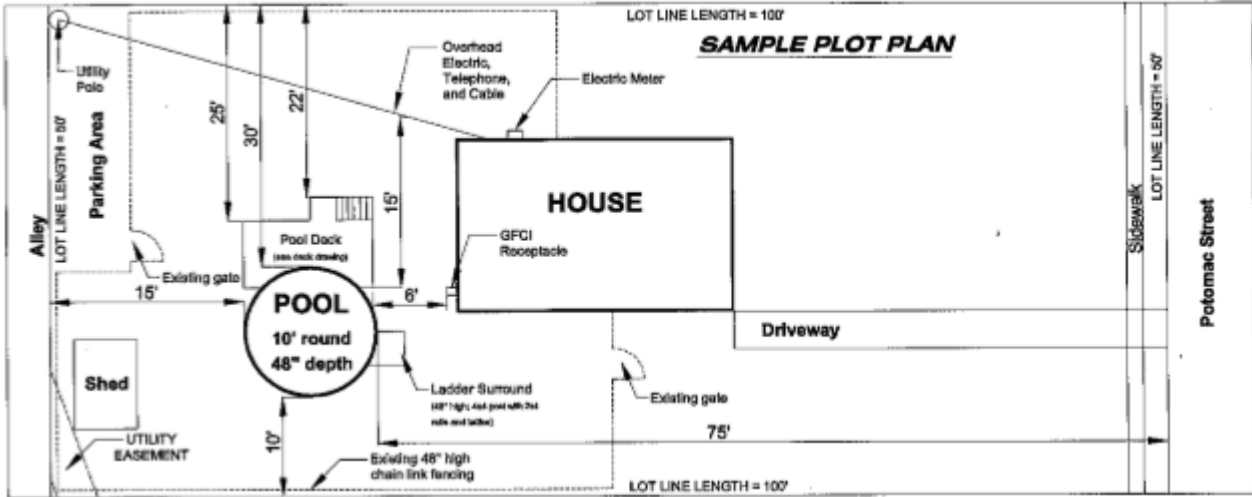

Note: A professionally prepared location survey may be submitted in lieu of the plot plan drawing below.

PLOT PLAN

(provide your plot plan in the space provided here)